



## STAUFF TEST ADAPTORS

# STAUFF TEST



STAUFF  
ANGLIA



**Stauff Anglia Limited**

405 Coppersmith Way | Wymondham | Norfolk NR18 0WY

**T: 01953 857158 F: 01953 857159 E: [Sales@stauffanglia.co.uk](mailto:Sales@stauffanglia.co.uk)**

**[www.stauffanglia.co.uk](http://www.stauffanglia.co.uk)**

## Thread Adaptor SRS20

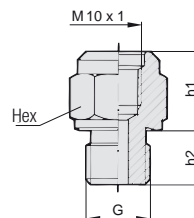

### Metal Parts

Standard Material SRS20:

Steel, zinc/nickel-plated = **C6F (CrVI-free)**

For ordering V2A (1.4305 / AISI 303) replace "C6F" with "V2A".

For ordering V4A (1.4571 / AISI 316Ti) replace "C6F" with "V4A".

### Sealings

For ordering FPM sealings replace "P" with "V".

For ordering EPDM sealings replace "P" with "E".

\* Standard option for North America is FPM (Viton®).

### Sealing Details



Metal Joint Type B



Elastomeric Sealing Type C



Taper Type D  
(suitable sealant required)



O-ring Type E

Thread	Sealing	Dimensions (mm/in)			Order Codes
		h1	h2	Hex	
G					
M10 x 1		15,5	8,5	17	SRS20-M10x1-B-C6F
		.61	.33	.67	
M12 x 1,5		15	12	19	SRS20-M12x1,5-B-C6F
		.59	.47	.75	
M14 x 1,5		15	12	19	SRS20-M14x1,5-B-C6F
		.59	.47	.75	
M16 x 1,5		8	12	22	SRS20-M16x1,5-B-C6F
		.31	.47	.87	
M18 x 1,5	Type B	15	12	24	SRS20-M18x1,5-B-C6F
		.59	.47	.94	
M22 x 1,5		10,5	14	27	SRS20-M22x1,5-B-C6F
		.41	.55	1.06	
G1/8		15,5	8	17	SRS20-G1/8-B-C6F
		.61	.31	.67	
G1/4		15	12	19	SRS20-G1/4-B-C6F
		.59	.47	.75	
G3/8		10,5	12	22	SRS20-G3/8-B-C6F
		.41	.47	.87	
G1/2		10,5	14	27	SRS20-G1/2-B-C6F
		.41	.55	1.06	
M12 x 1,5		15	12	19	SRS20-M12x1,5-PC-C6F
		.59	.47	.75	
M14 x 1,5		15	12	19	SRS20-M14x1,5-PC-C6F
		.59	.47	.75	
M18 x 1,5		15	12	24	SRS20-M18x1,5-PC-C6F
		.59	.47	.94	
G1/8	Type C	16	8	17	SRS20-G1/8-PC-C6F
		.63	.31	.67	
G1/4		15	12	19	SRS20-G1/4-PC-C6F
		.59	.47	.75	
G3/8		10,5	12	22	SRS20-G3/8-PC-C6F
		.41	.47	.87	
G1/2		10,5	14	27	SRS20-G1/2-PC-C6F
		.41	.55	1.06	
R1/4 K		13	12	17	SRS20-R1/4K-D-C6F
		.51	.47	.67	
R3/8 K		13	14	19	SRS20-R3/8K-D-C6F
		.51	.55	.75	
R1/2 K	Type D	8	19	22	SRS20-R1/2K-D-C6F
		.31	.75	.87	
1/4 NPT		10	15	17	SRS20-1/4NPT-D-C6F
		.39	.59	.67	
1/2 NPT		8	20	22	SRS20-1/2NPT-D-C6F
		.31	.79	.87	
7/16-20 UNF		9	9,1	17	SRS20-7/16UNF-PE-C6F
		.35	.36	.67	
1/2-20 UNF		15	9,2	17	SRS20-1/2UNF-PE-C6F
		.59	.36	.67	
9/16-18 UNF		15,5	10	19	SRS20-9/16UNF-PE-C6F
		.61	.39	.75	
7/8-14 UNF		11	16	27	SRS20-7/8UNF-PE-C6F
		.43	.63	1.06	
M14 x 1,5	Type E	14,5	11	19	SRS20-M14x1,5-PE-C6F
		.57	.43	.75	
M16 x 1,5		8,5	12,5	22	SRS20-M16x1,5-PE-C6F
		.33	.49	.87	
M22 x 1,5		10	15	27	SRS20-M22x1,5-PE-C6F
		.39	.59	1.06	
M27 x 2		10	18,5	32	SRS20-M27x2-PE-C6F
		.39	.73	1.26	

## Thread Adaptor SRS15

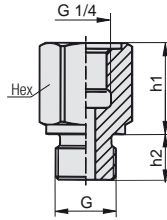

Thread	Sealing	Dimensions (mm/in)			Order Codes
		h1	h2	Hex	
<b>G</b>					
M14 x 1,5	Type B	24	12	19	SRS15-M14x1,5-B-C6F
		.95	.47	.75	
M16 x 1,5		24	12	22	SRS15-M16x1,5-B-C6F
		.95	.47	.87	
M18 x 1,5		24	12	24	SRS15-M18x1,5-B-C6F
		.95	.47	.95	
M20 x 1,5		10,5	14	27	SRS15-M20x1,5-B-C6F
		.41	.55	1.06	
G3/8		24	12	22	SRS15-G3/8-B-C6F
		.95	.47	.87	
G1/2	10,5	14	27	SRS15-G1/2-B-C6F	
	.41	.55	1.06		
M14 x 1,5	Type C	24	12	19	SRS15-M14x1,5-PC-C6F
		.95	.47	.75	
M16 x 1,5		24	12	22	SRS15-M16x1,5-PC-C6F
		.95	.47	.87	
M18 x 1,5		24	12	24	SRS15-M18x1,5-PC-C6F
		.95	.47	.95	
G3/8		24	12	22	SRS15-G3/8-PC-C6F
			.95	.47	

### Metal Parts

Standard material SRS15:

Steel, zinc/nickel-plated = **C6F (CrVI-free)**

For ordering V2A (1.4305 / AISI 303) replace "C6F" with "V2A".

For ordering V4A (1.4571 / AISI 316Ti) replace "C6F" with "V4A".

### Sealings

For ordering FPM sealings replace "P" with "V".

For ordering EPDM sealings replace "P" with "E".

\* Standard option for North America is FPM (Viton®).

### Sealing Details



Metal Joint Type B



Elastomeric Sealing Type C

## Welding Adaptor SAS

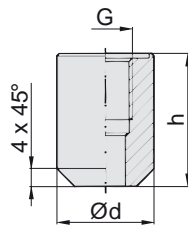

Thread	Port Connection	Dimensions (mm/in)		Order Codes
		h	Ød	
<b>G</b>				
M10 x 1	Type A	25	20	SAS-M10x1
		.98	.79	
G1/8	Type B/C	25	20	SAS-G1/8
		.98	.79	
G1/4		30	22	SAS-G1/4
		1.18	.87	
G3/8		30	25	SAS-G3/8
		1.18	.98	
1/4 NPT	Type D	25	20	SAS-1/4NPT
		.98	.79	
1/2-20 UNF	Type E	25	20	SAS-1/2UNF
		.98	.79	

### Metal Parts

Standard material: **S235 (St 37), phosphated**